

8.4

ERECTED . 1906 .
 TYPE . BRICK
 FOUNDATION . CONCRETE
 WALLS . 13" BRICK
 ROOF . { TYPE . HIP - TILE .
 { PITCH . APPROX. $\frac{1}{3}$. PITCH .
 HEATING . NATURAL GAS STOVES .

FLOOR . $\frac{7}{8}$ " x $\frac{3}{4}$ " YELLOW PINE .
 FINISH . { INSIDE . ROUGH PLASTER .
 { OUTSIDE . PRESSED BRICK
 CEILING HEIGHTS . 13'- $\frac{1}{2}$ " WAITING ROOMS; T.O.; E. BAGGAGE ROOM .
 LIGHTING . ELECTRIC LIGHT; (2-WIRE 110 A.C.)
 SANITARY FACILITIES . INSIDE TOILETS .

DIV. CENTRAL
 SUB. DIV. ARK/NOB
 STA. NO. W-680

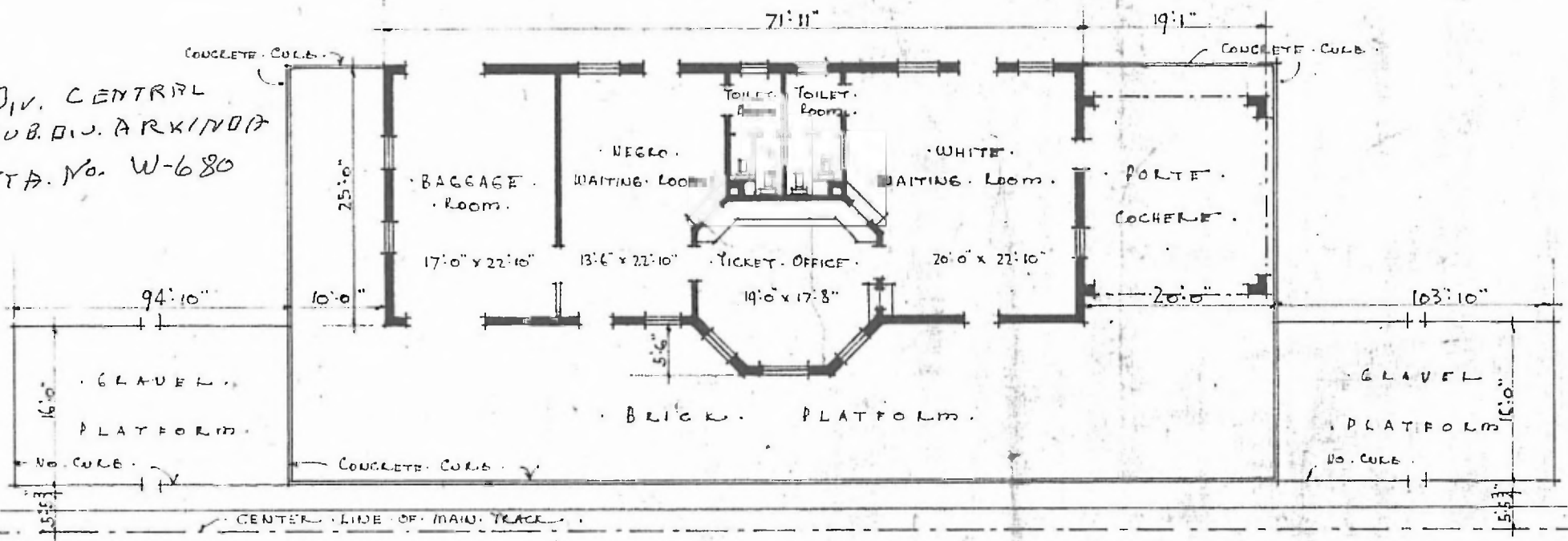

COMBINATION STATION AT
 HOPE - ARKANSAS

FLOOR PLAN
 SCALE: $\frac{1}{16}$ " = 1'-0"

N.
 July 5, 1915.