

ERECTED

TYPE

FOUNDATION

WALLS

ROOF { TYPE  
PITCH

HEATING

FRAME

PILE HEADS

2"x6"

GABLE SHINGLES

1/4

STOVES

FLOOR

FINISH

OUTSIDE

INSIDE

CEILING

LIGHTING

SANITARY FACILITIES

7/8" x 3 1/4"

BOX & BAT. DROP SIDING

7/8" x 3 1/4" MATCH & BEED

7/8" x 3 1/4" WAIT ROOM 11'-0" BAGG. RM. 12'-3" OPEN

OIL

OUTSIDE TOILETS

DIV. SOUTHERN  
SUB. MEMPHIS  
STA. NO. C-358

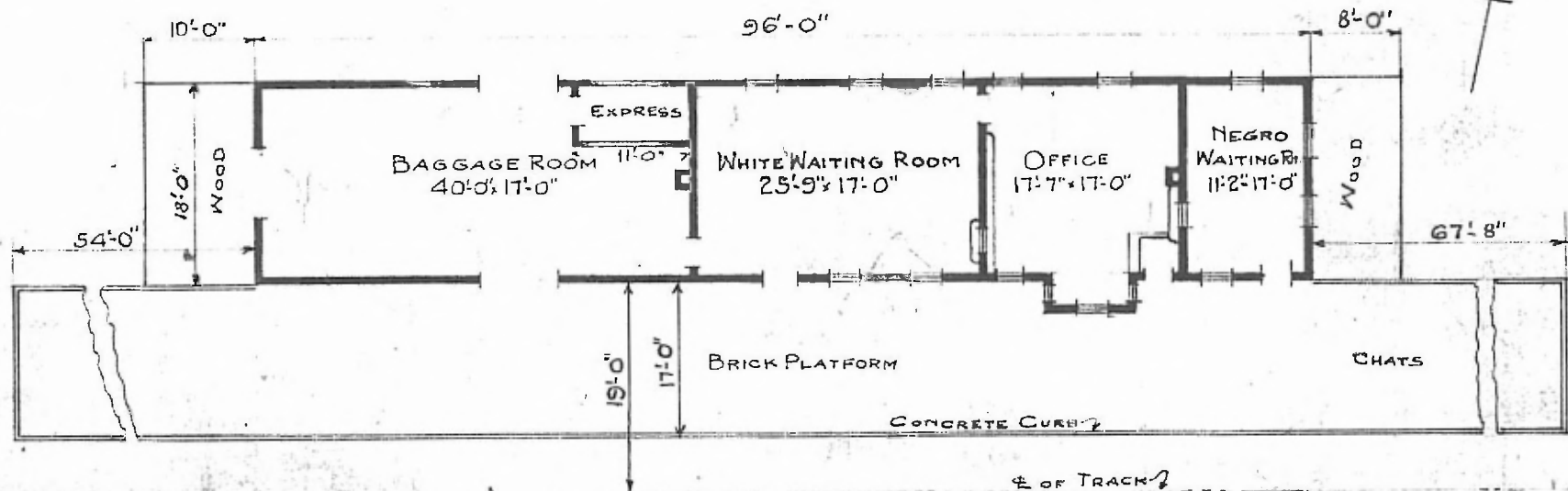

FLOOR PLAN  
SCALE: 1/16" = 1'-0"

PASSENGER STATION AT  
HARDY, ARK.

OCT. 1, 1917.