

ERECTED.
 TYPE. FRAME.
 FOUNDATION. PILE HEADS.
 WALLS. 2" x C". STUDS.
 ROOF. { TYPE. GABLE - SHINGLES.
 PITCH. APPROX. 1/3 - PITCH.
 HEATING. STOVES.

FLOOR. 7/8" x 3 1/2". YELLOW PINE.
 FINISH. { INSIDE 7/8" x 3 1/2" MATCHED E. BEADED
 OUTSIDE BOARDS E. BATTENS.
 CEILING HEIGHTS. 11'-10" WAITING RMS; 7'-0"; 12'-0" FREIGHT. Rm (OPEN)
 LIGHTING. OIL LAMPS.
 SANITARY FACILITIES. OUTSIDE TOILETS.

DIV. SOUTHERN
 SUB. MEMPHIS
 STR. NO. 4459

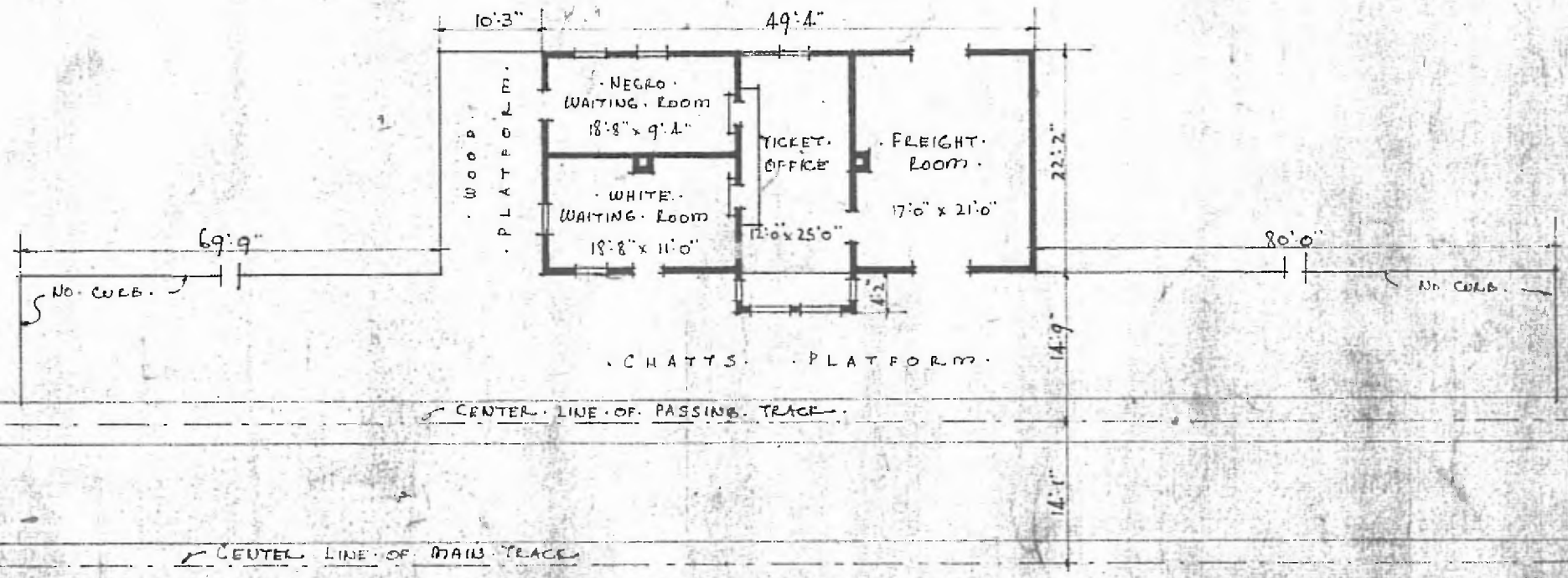

FLOOR PLAN
 SCALE 1/16" = 1'-0"

COMBINATION - STATION - AT
 GILMORE - ARKANSAS

AUGUST.
 8 - 1917.