

ERECTED. 1903
 TYPE. STONE
 FOUNDATION. STONE
 WALLS. 18"
 ROOF { TYPE. FLAT. CMP. HIP. SLATE.
 PITCH
 HEATING. STEAM.

FLOOR. 3/4 x 3' Y. PINE.
 FINISH { INSIDE. PLASTER.
 OUTSIDE STONE.
 STORY HEIGHT. 13' 11" 2ND 11' 9"
 LIGHTING.
 SANITARY FACILITIES. INSIDE TOILET.

DIV. CENTRAL
 SUB. DIV. FT. SMITH
 STA. NO. 415

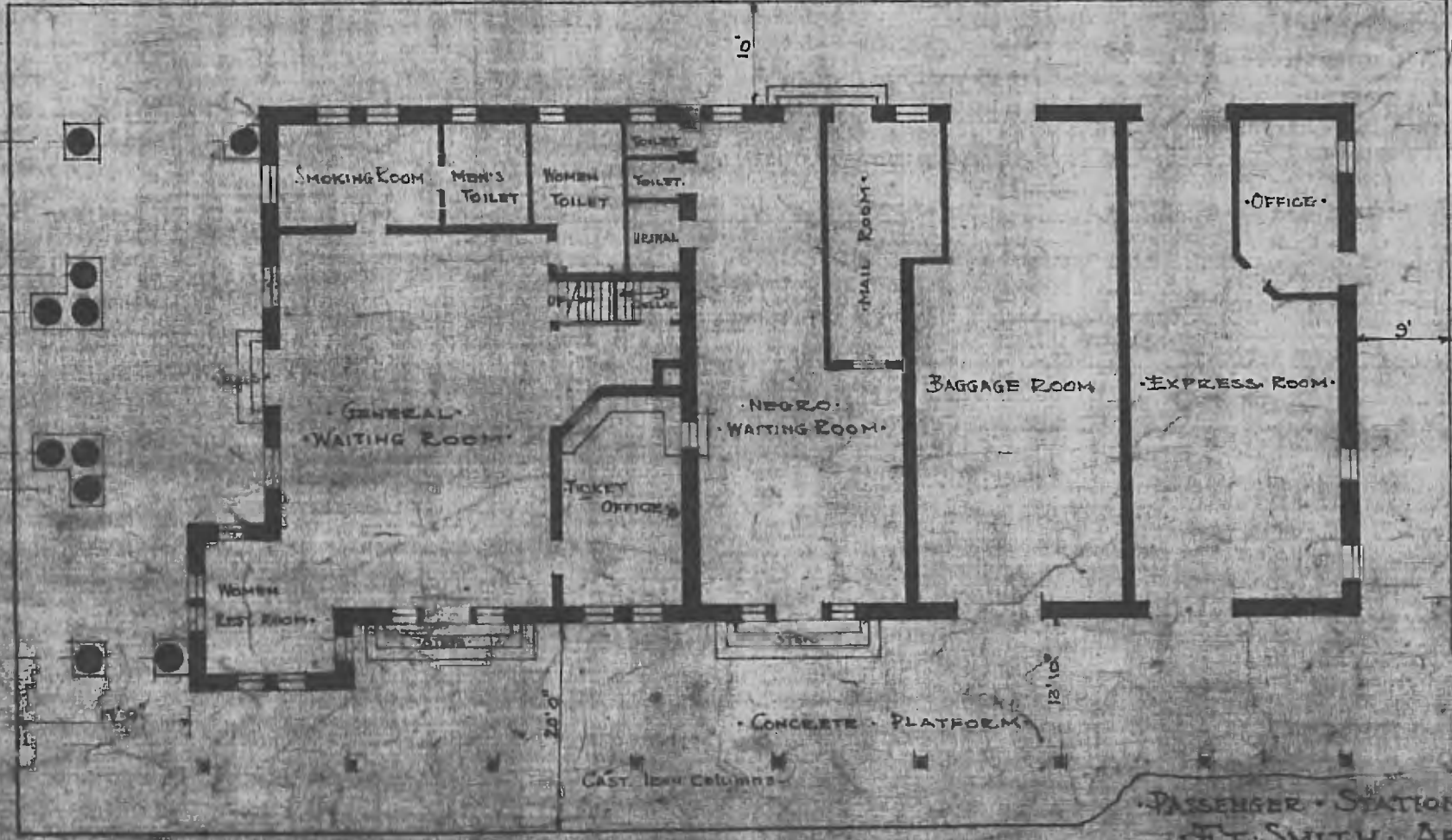

FIRST FLOOR PLAN.

PASSENGER STATION AT
 FT. SMITH, ARK.