

ERECTED 1905  
 TYPE FRAME  
 FOUNDATION TIMBER  
 WALLS 2x6  
 ROOF { TYPE GABLE SHINGLES  
 PITCH  $\frac{1}{3}$   
 HEATING STOVES

FLOOR 4x3 $\frac{1}{2}$  Y.P.  
 FINISH { INSIDE 3/4x3 $\frac{1}{2}$  BEADED CEILING  
 OUTSIDE 1x6 DROP SIDING  
 CEILING HEIGHT 11'-5"  
 LIGHTING OIL LAMPS  
 SANITARY FACILITIES OUTSIDE TOILETS

SUB. CHAFFICE  
 STA. NO. T 275

51

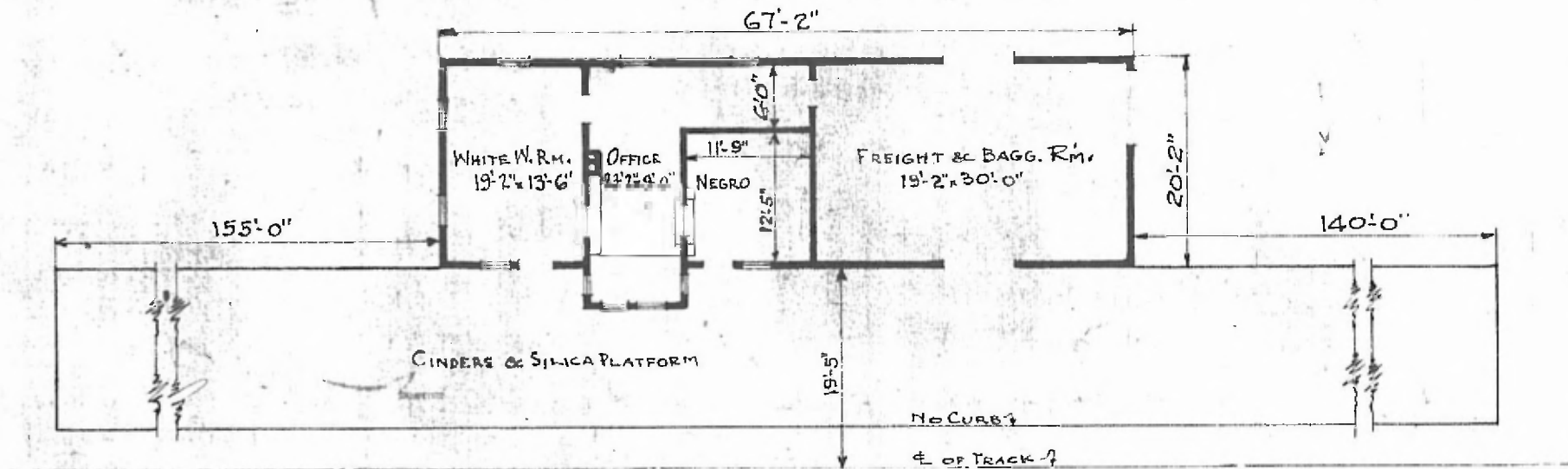

FLOOR PLAN  
 SCALE:  $\frac{1}{16}$ " = 1'-0"

COMBINATION STATION  
 FRENCHMANS BAYOU, ARK.

OCT. 10, 1919