

ERECTED 1926.
 TYPE BRICK.
 FOUNDATION CONCRETE.
 WALLS 13" BRICK-STUCCO.
 ROOF {TYPE SHINGLE TILES
 PITCH APPROX. 1/3 PITCH.
 HEATING STEAM

FLOOR FINISH {INSIDE
 OUTSIDE
 CEILING HEIGHT.
 LIGHTING
 FACILITIES

WTG. ROOM-ASBESTOLITH-EXP. RM, CEMENT.
 BAGG. RM. CONCRETE. OFFICE. WOOD
 PLASTER-STUCCO.
 WTG. RM. - 11'6" BAGG. & FRT. - 14'-2"
 ELECTRIC.
 INSIDE-TOILETS.

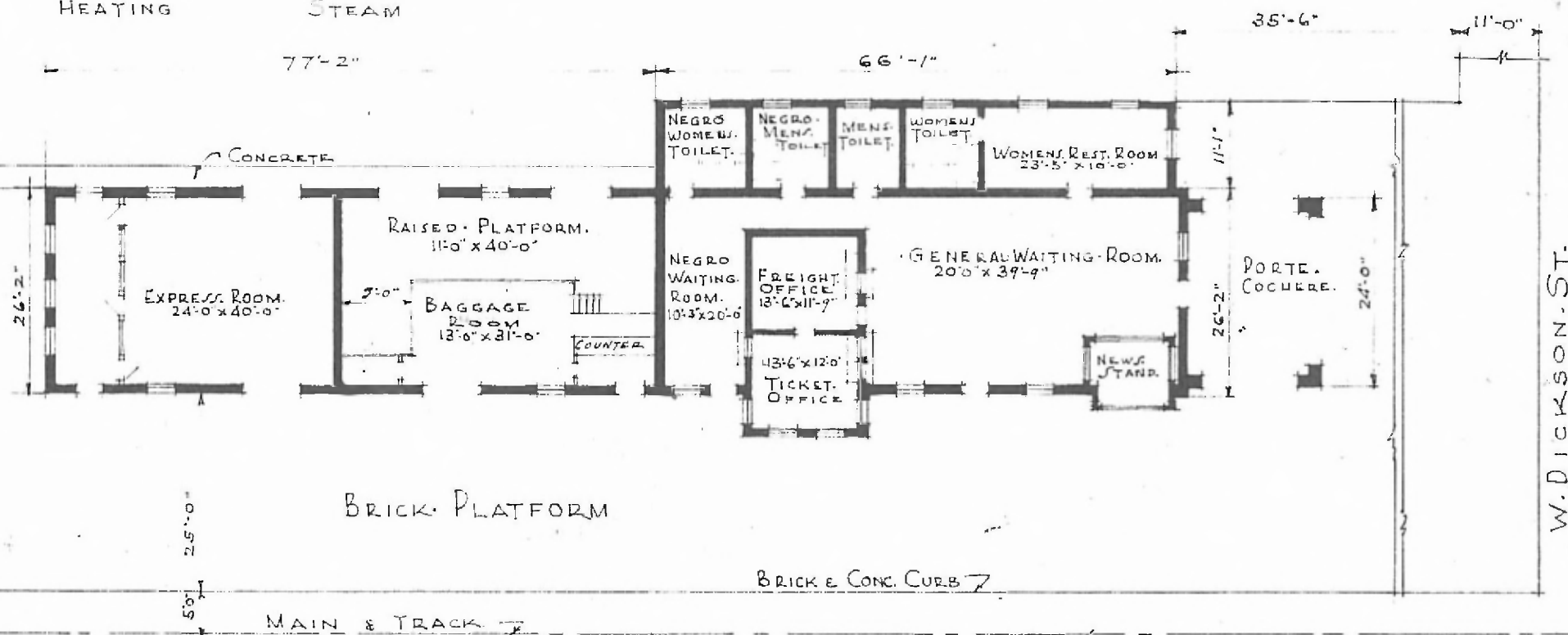

FLOOR PLAN
 SCALE 1" = 20'-0"

DIV. CENTRAL
 SUB. DIV. FT. SMITH
 STA. No. 352



JULY. 14. 1926.

PASSENGER STATION AT
 FAYETTEVILLE ARK.