

DIV. CENTRAL
 SUB. DIV. FT. SMITH
 STA. No. B 338

ERECTED
 TYPE BRICK
 FOUNDATION STONE & CONCRETE
 WALLS 13"
 ROOF { TYPE FLAT
 PITCH
 HEATING STOVES

FLOOR CONCRETE, WOOD IN TICKET OFFICE.
 FINISH { INSIDE PLASTER & CEMENT
 OUTSIDE BRICK.
 CEILING HEIGHT. 12'-0"
 LIGHTING ELECTRIC. 2 WIRE 110 A.C.
 NITARY FACILITIES. OUTSIDE TOILET

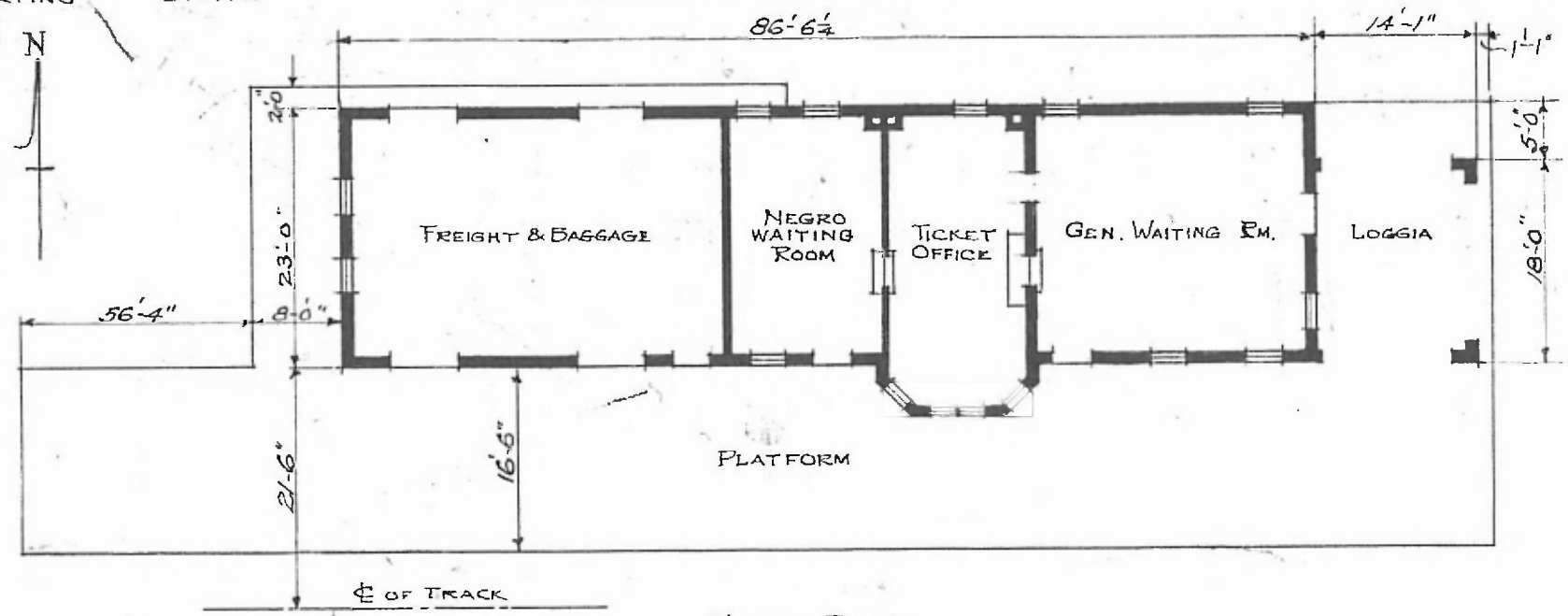

FLOOR PLAN
 SCALE $\frac{1}{16} = 1'-0"$

• COMBINATION • STATION • AT •
 • BENTONVILLE • ARK.

REVISED - SEPT. 17, '17.
 . AUG. 4, 1915.