

92

ERECTED. 1902.
 TYPE. FRAME.
 FOUNDATION. PILE HEADS.
 WALLS. 2" X 4"
 ROOF { TYPE. HIP SHINGLES.
 PITCH. 1/3
 HEATING. STOVES.

FLOOR. 3/4" X 3/4"
 FINISH { INSIDE. BD. CEILING.
 OUTSIDE BOARD & BATTIS.
 CEILING HEIGHT. 12' 1"
 LIGHTING. LAMPS.
 SANITARY FACILITIES. OUTSIDE TOILET.

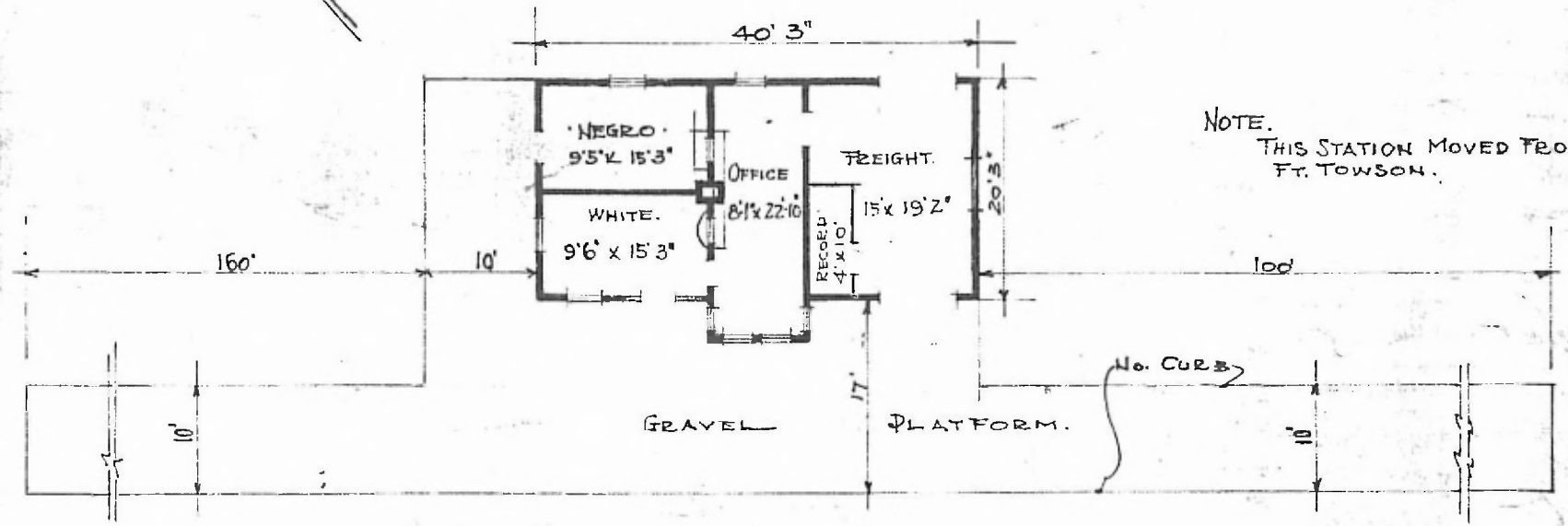
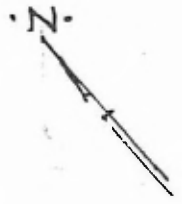

NOTE.
 THIS STATION MOVED FROM
 FT. TOWSON.

DIV. CENTRAL
 SUB. DIV. ARKINDA
 STA. NO. W-625

COMBINATION STATION AT
 ARKINDA ARK.

JUNE 25 1915