

ERECTED. - 1908.  
 TYPE. FRAME.  
 FOUNDATION. - PILE HEADS.  
 WALLS. 2"X4"  
 ROOF { TYPE. HIP. SHINGLES.  
 PITCH. 1/3  
 HEATING. - STOVES.

FLOOR. 1'X6" Y. PINE.  
 FINISH { INSIDE. 5/2" X 5 1/2" Bd. CEILING.  
 OUTSIDE. BOARD & BATTES.  
 CEILING HEIGHT. 11'0"  
 LIGHTING. - LAMPS.  
 SANITARY FACILITIES. - OUTSIDE. TOILETS.

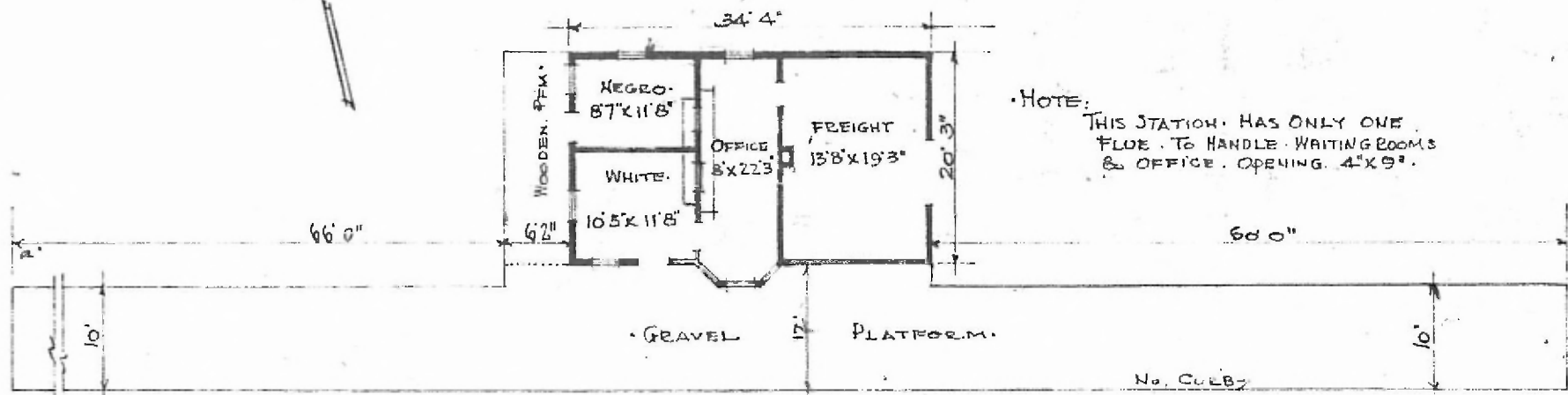

FLOOR PLAN  
 SCALE 1/16" = 1'0"

DIV. CENTRAL  
 SUB. DIV. ARTHUR  
 STA. NO. W638

COMBINATION STATION AT  
 ARDEN ARK.

JULY 6 1915