

ERECTED  
 TYPE  
 FOUNDATION  
 WALLS  
 ROOF { TYPE  
 PITCH  
 HEATING

1918  
 FRAME  
 CONCRETE  
 2"x6"  
 HIP-WOOD SHINGLES  
 1/2"  
 STOVES

FLOOR  
 FINISH { INSIDE  
 OUTSIDE  
 CEILING HEIGHT  
 LIGHTING  
 SANITARY FACILITIES

1" x 2 1/4"  
 1" x 3 1/4" M. & B.  
 1" x 3 1/4" DROP SIDING  
 WAITING RM. 11'-4" FRT. RM. 12'-0"  
 OIL LAMPS  
 OUTSIDE TOILETS.

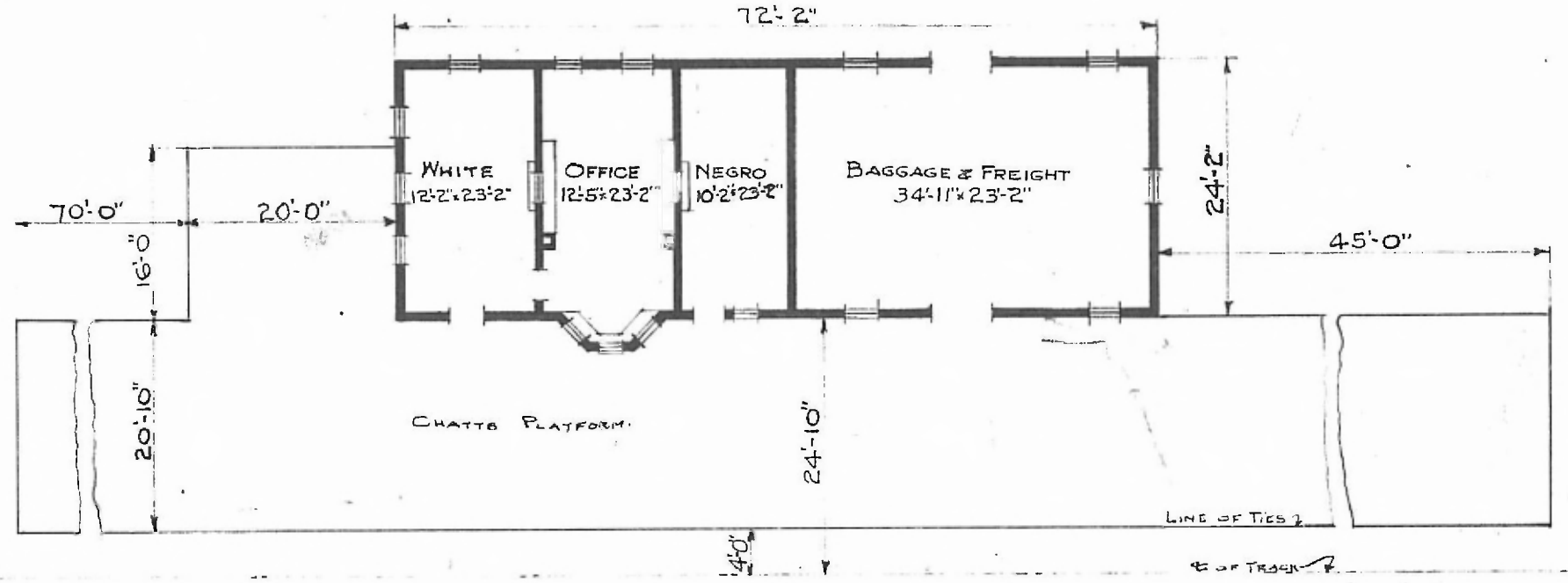

FLOOR PLAN  
 SCALE: 1/16" = 1'-0"

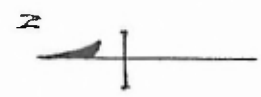

COMBINATION STATION AT  
 ADAMSVILLE, ALA.